

GenGrip

Set Screw & Hydraulic Clamping System For ID Drilling, Milling, & Boring

- Set Screws For Large Tool Bores & Economy
- Easy Clamping Hydraulic System For Micro Tools
- Maintains Exceptional TIR Down To (.00004in)
- Activate Clamping From Front Or Rear Of Tool Block
- Extended Tool Life With Vibration Dampening
- High Boring Bar Positioning Accuracy
- Coolant-Thru



GenGrip Keeps Your ID Tool Straight And On Center

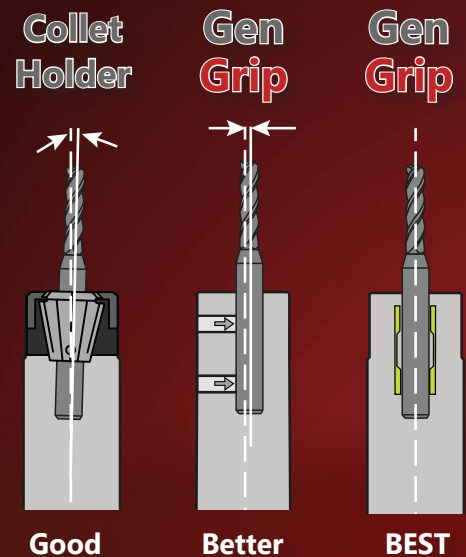
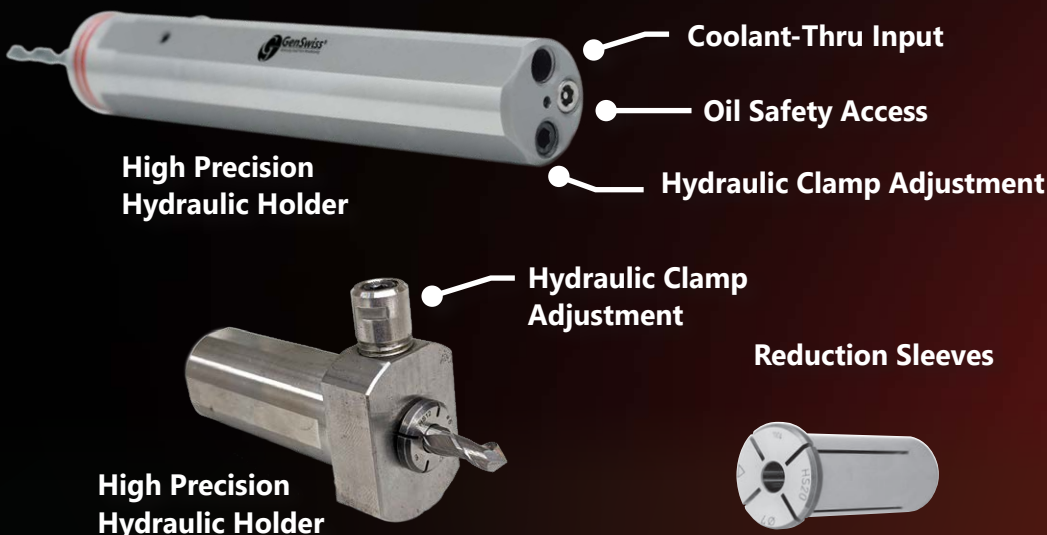

Stop Wasting Time Making Parts You Don't Get Paid For...

GenSwiss drill sleeves are a new product designed and manufactured by GenSwiss. These sleeves have precision ground inch and metric shanks and are a robust method for holding drills to tight tolerances. Each GenSwiss drill sleeve features coolant-thru holes, enabling coolant delivery to your coolant-thru drills. Standard tool bore sizes range from 3-8mm, but drill sleeves can be made to order.



- **1/8-28 BSPP Coolant Fitting**
- **Precision Ground Shanks**
- **3mm - 8mm Tool Bore Sizes**

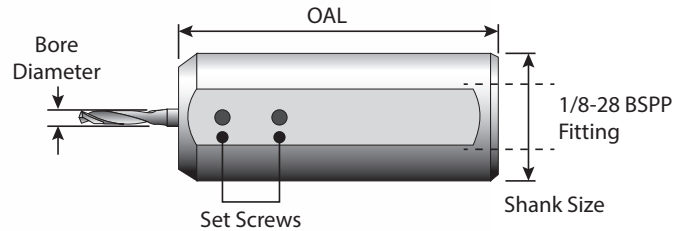

Drill Sleeves

Item No.	Description	Shank Size	OAL	Set Screw	Bore Diameter
1027-000100	CTS-3.00-158760	5/8in	3in	M4	3mm
1027-000101	CTS-3.18-158760		3in	M4	1/8in
1027-000102	CTS-4.00-158760		3in	M4	4mm
1027-000103	CTS-4.76-158760		3in	M4	3/16in
1027-000104	CTS-6.00-158760		3in	M6	6mm
1027-000105	CTS-6.35-158760		3in	M6	1/4in
1027-000106	CTS-7.94-158760		3in	M6	5/16in
1027-000107	CTS-8.00-158760		3in	M6	8mm
1027-000108	CTS-3.00-190760	3/4in	3in	M4	3mm
1027-000109	CTS-3.18-190760		3in	M4	1/8in
1027-000110	CTS-4.00-190760		3in	M4	4mm
1027-000111	CTS-4.76-190760		3in	M4	3/16in
1027-000112	CTS-6.00-190760		3in	M6	6mm
1027-000113	CTS-6.35-190760		3in	M6	1/4in
1027-000114	CTS-7.94-190760		3in	M6	5/16in
1027-000115	CTS-8.00-190760		3in	M6	8mm
1027-000116	CTS-3.00-200760	20mm	3in	M4	3mm
1027-000117	CTS-3.18-200760		3in	M4	1/8in
1027-000118	CTS-4.00-200760		3in	M4	4mm
1027-000119	CTS-4.76-200760		3in	M4	3/16in
1027-000120	CTS-6.00-200760		3in	M6	6mm
1027-000121	CTS-6.35-200760		3in	M6	1/4in
1027-000122	CTS-7.94-200760		3in	M6	5/16in
1027-000123	CTS-8.00-200760		3in	M6	8mm
1027-000124	CTS-3.00-220760	22mm	3in	M4	3mm
1027-000125	CTS-3.18-220760		3in	M4	1/8in
1027-000126	CTS-4.00-220760		3in	M4	4mm
1027-000127	CTS-4.76-220760		3in	M4	3/16in
1027-000128	CTS-6.00-220760		3in	M6	6mm
1027-000129	CTS-6.35-220760		3in	M6	1/4in
1027-000130	CTS-7.94-220760		3in	M6	5/16in
1027-000131	CTS-8.00-220760		3in	M6	8mm
1027-000132	CTS-3.00-254760	1in	3in	M4	3mm
1027-000133	CTS-3.18-254760		3in	M4	1/8in
1027-000134	CTS-4.00-254760		3in	M4	4mm
1027-000135	CTS-4.76-254760		3in	M4	3/16in
1027-000136	CTS-6.00-254760		3in	M6	6mm
1027-000137	CTS-6.35-254760		3in	M6	1/4in
1027-000138	CTS-7.94-254760		3in	M6	5/16in
1027-000139	CTS-8.00-254760		3in	M6	8mm

Hydraulic Clamps Activated From Front Of Tool Block

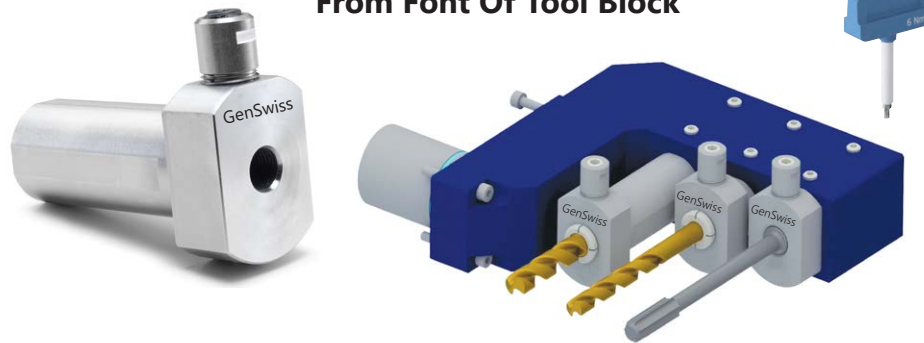

Set screws are used to clamp on the milled flat, after adjusting the length of the assembly.

Hydraulic Clamping - Front Activated

Dimensions (mm)

Item No.	Description	D1	D2	D3	D4	L1	L2	L3	L4	L5	L6	Depth	Thread
Call For Details	HYC-12-1905-064F	12	19.05	40	12	64	50	21.5	33	18.05	7	40	M5x0.8 - 6H
Call For Details	HYC-12-1905-089F	12	19.05	40	12	89	75	21.5	33	18.05	16	40	M5x0.8 - 6H
Call For Details	HYC-12-2000-089F	12	20	40	12	89	75	24.5	33	19	16	40	M5x0.8 - 6H
1033-000109	HYC-12-2500-164F	12	25	40	12	164	150	27.5	33	24	16	40	M5x0.8 - 6H
Call For Details	HYC-12-2504-069F	12	25.4	40	12	69	55	27.5	33	24.4	12	40	M5x0.8 - 6H
Call For Details	HYC-12-2504-114F	12	25.4	40	12	114	100	27.5	33	24.4	16	40	M5x0.8 - 6H

NOTE: Use with torque wrench 1033-000132

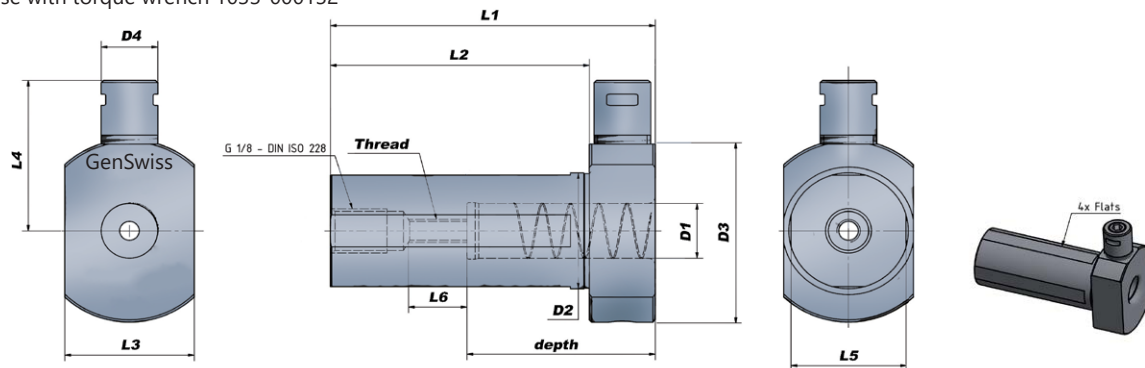

Torque Wrench:

Use preset Torque Wrench to ensure correct mounting of tools.
6 Nm - Part no. **1033-000132**

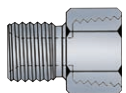

Adapters:

Male G 1/8" to Female 1/8" NPT
Part no. **1033-000154**

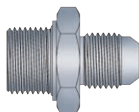

Male G 1/8" to Male 1/4" JIC
Part no. **1033-000153**

Reduction Sleeves

GENGRIP (High Precision) can be used with reduction sleeves, providing a wide range of tool sizes for hydraulic clamping. GenGrip does not utilize ER-Collets.

**Minimal Flex
High Accuracy
3mm - 10mm Bore Sizes**



Item No.	Description	Tool Size	Coolant Type
1033-000133	HYCS-12-3.00	3mm	Internal
1033-000134	HYCS-12-3.00-CF	3mm	External
1033-000135	HYCS-12-3.17	3.17mm	Internal
1033-000136	HYCS-12-4.00	4mm	Internal
1033-000137	HYCS-12-4.00-CF	4mm	External
1033-000138	HYCS-12-4.76	4.76mm	Internal
1033-000139	HYCS-12-5.00	5mm	Internal
1033-000140	HYCS-12-5.00-CF	5mm	External
1033-000141	HYCS-12-6.00	6mm	Internal
1033-000142	HYCS-12-6.00-CF	6mm	External
1033-000143	HYCS-12-6.35	6.35mm	Internal
1033-000144	HYCS-12-7.00	7mm	Internal
1033-000145	HYCS-12-7.94	7.94mm	Internal
1033-000146	HYCS-12-8.00	8mm	Internal
1033-000147	HYCS-12-8.00-CF	8mm	External
1033-000148	HYCS-12-9.00	9mm	Internal
1033-000149	HYCS-12-9.52	9.52mm	Internal
1033-000150	HYCS-12-10.0	10mm	Internal



To prevent damage to the holder, round tool shanks without flats and with H6 tolerance **MUST** be used. Tool **MUST** be in the holder when clamping. Torque wrench **REQUIRED**.

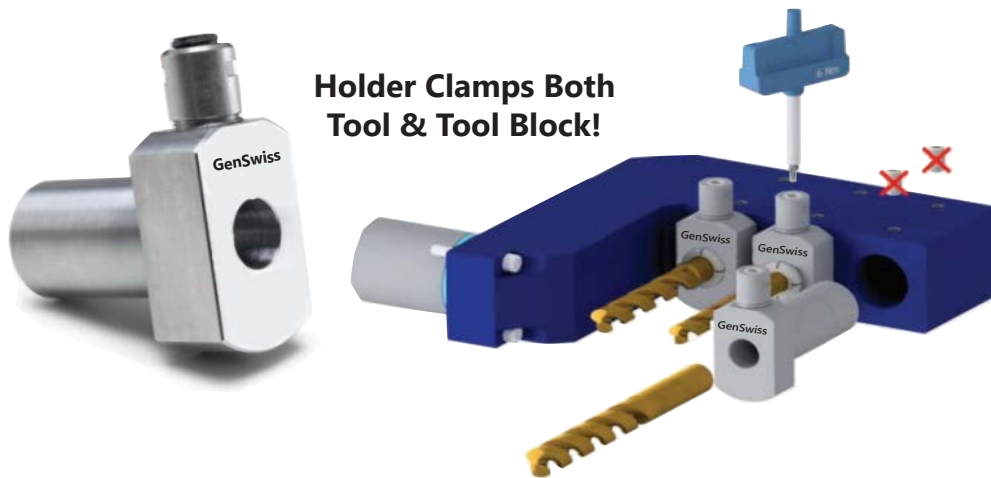

**Holder Clamps Both
Tool & Tool Block!**



Block/holder set screws are NOT used!

Hydraulic Clamping - Dual Action

Dimensions (mm)

Item No.	Description	D1	D2	D3	D4	L1	L2	L3	L4	Dimensions With Back Stop / Coolant Port		
										L5	D5	Back Stop / Coolant Port Compatible
1033-000100	HYC-12-1905-045D	12	19.05	40	12	45	31	21.5	33	61	18.85	Yes
1033-000101	HYC-12-2000-045D	12	20	40	12	45	31	24.5	33	61	18.85	Yes
1033-000102	HYC-12-2200-045D	12	22	40	12	45	31	24.5	33	61	18.85	Yes
1033-000103	HYC-12-2500-045D	12	25	40	12	45	31	27.5	33	61	18.85	Yes
1033-000104	HYC-12-2504-045D	12	25.4	40	12	45	31	27.5	33	61	18.85	Yes
1033-000105	HYC-20-2500-044D	20	25	44	12	44	30	27.5	35			
1033-000106	HYC-20-2504-044D	20	25.4	44	12	44	30	27.5	35			
Call For Details	HYC-25-3175-048D	25	31.75	50	12	48	34	34.5	38			
1033-000107	HYC-25-3200-048D	25	32	50	12	48	34	34.5	38			



NOTE: Use with torque wrench 1033-000132

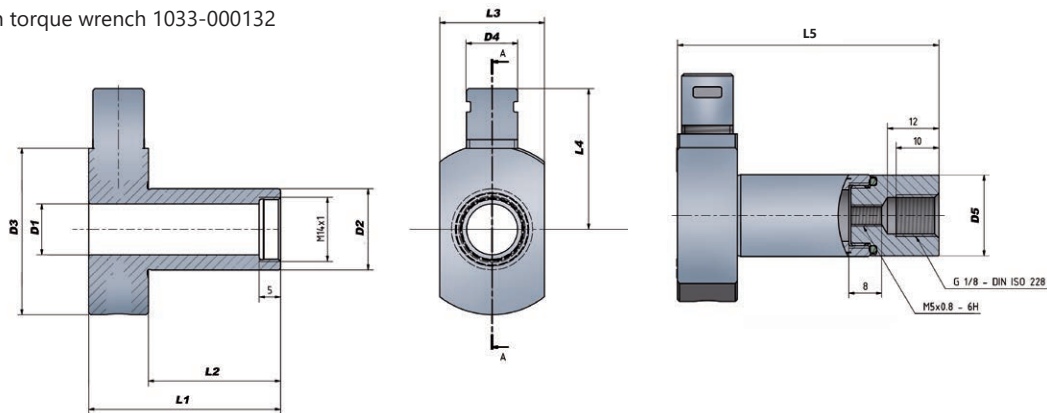

Torque Wrench:

Use preset Torque Wrench to ensure correct mounting of tools. 6 Nm - Part no. **1033-000132**



Coolant Port:

Coolant Port G 1/8", Backstop screw M5x0.8-16, Part no. **1033-000151**

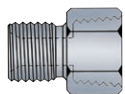

Adapters:

Male G 1/8" to Female 1/8" NPT Part no. **1033-000154**

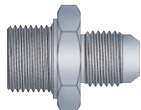

Male G 1/8" to Male 1/4" JIC Part no. **1033-000153**

Reduction Sleeves

GENGRIP (High Precision) can be used with reduction sleeves, providing a wide range of tool sizes for hydraulic clamping. GenGrip does not utilize ER-Collets.

**Minimal Flex
High Accuracy
3mm - 10mm Bore Sizes**



Item No.	Description	Tool Size	Coolant Type
1033-000133	HYCS-12-3.00	3mm	Internal
1033-000134	HYCS-12-3.00-CF	3mm	External
1033-000135	HYCS-12-3.17	3.17mm	Internal
1033-000136	HYCS-12-4.00	4mm	Internal
1033-000137	HYCS-12-4.00-CF	4mm	External
1033-000138	HYCS-12-4.76	4.76mm	Internal
1033-000139	HYCS-12-5.00	5mm	Internal
1033-000140	HYCS-12-5.00-CF	5mm	External
1033-000141	HYCS-12-6.00	6mm	Internal
1033-000142	HYCS-12-6.00-CF	6mm	External
1033-000143	HYCS-12-6.35	6.35mm	Internal
1033-000144	HYCS-12-7.00	7mm	Internal
1033-000145	HYCS-12-7.94	7.94mm	Internal
1033-000146	HYCS-12-8.00	8mm	Internal
1033-000147	HYCS-12-8.00-CF	8mm	External
1033-000148	HYCS-12-9.00	9mm	Internal
1033-000149	HYCS-12-9.52	9.52mm	Internal
1033-000150	HYCS-12-10.0	10mm	Internal



To prevent damage to the holder, round tool shanks without flats and with H6 tolerance MUST be used. Tool MUST be in the holder when clamping. Torque wrench REQUIRED.

Hydraulic Clamps Activated From Back Of Tool Block

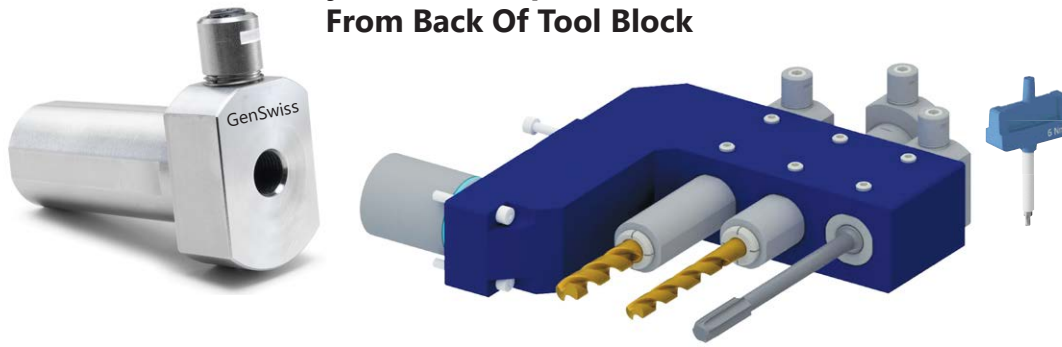

Set screws are used to clamp on the milled flat, after adjusting the length of the assembly.

Hydraulic Clamping - Rear Activated

Dimensions (mm)

Item No.	Description	D1	D2	D3	D4	L1	L2	L3	L4	L5	L6	Depth	Thread
1033-000110	HYC-12-1905-064B	12	19.05	40	12	64	50	21.5	33	21	9	40	M5x0.8 - 6H
1033-000111	HYC-12-1905-089B	12	19.05	40	12	89	75	21.5	33	21	10	40	M5x0.8 - 6H
1033-000112	HYC-12-1905-114B	12	19.05	40	12	114	100	21.5	33	21	10	40	M5x0.8 - 6H
1033-000113	HYC-12-2000-089B	12	20	40	12	89	75	24.5	33	21	10	40	M5x0.8 - 6H
1033-000114	HYC-12-2000-114B	12	20	40	12	114	100	24.5	33	21	10	40	M5x0.8 - 6H
1033-000115	HYC-12-2200-064B	12	22	40	12	64	50	24.5	33	21	9	40	M5x0.8 - 6H
1033-000116	HYC-12-2200-089B	12	22	40	12	89	75	24.5	33	21	10	40	M5x0.8 - 6H
1033-000117	HYC-12-2200-114B	12	22	40	12	114	100	24.5	33	21	10	40	M5x0.8 - 6H
1033-000118	HYC-12-2200-129B	12	22	40	12	129	115	24.5	33	21	10	40	M5x0.8 - 6H
1033-000119	HYC-12-2500-064B	12	25	40	12	64	50	27.5	33	24	9	40	M5x0.8 - 6H
1033-000120	HYC-12-2500-089B	12	25	40	12	89	75	27.5	33	24	10	40	M5x0.8 - 6H
1033-000121	HYC-12-2500-114B	12	25	40	12	114	100	27.5	33	24	10	40	M5x0.8 - 6H
1033-000122	HYC-12-2504-064B	12	25.4	40	12	64	50	27.5	33	24	9	40	M5x0.8 - 6H
1033-000123	HYC-12-2504-089B	12	25.4	40	12	89	75	27.5	33	24	10	40	M5x0.8 - 6H
1033-000124	HYC-12-2504-114B	12	25.4	40	12	114	100	27.5	33	24	10	40	M5x0.8 - 6H
Call For Details	HYC-20-3200-064B	20	32	40	12	64	50	34.5	33	30.8	9	52	M5x0.8 - 6H
Call For Details	HYC-20-3200-089B	20	32	40	12	89	75	34.5	33	30.8	10	52	M5x0.8 - 6H
Call For Details	HYC-20-3200-114B	20	32	40	12	114	100	34.5	33	30.8	10	52	M5x0.8 - 6H

NOTE: Use with torque wrench 1033-000132

HYC-20-3200-064B uses fitting 4005-000111 for coolant-thru capability

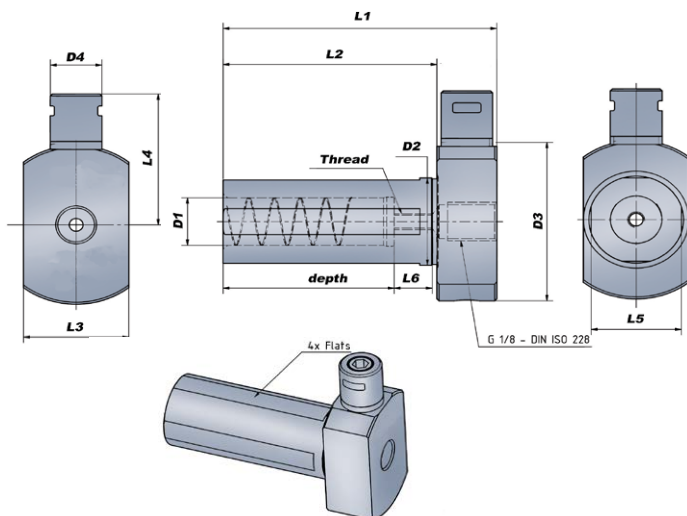

Torque Wrench:

Use preset Torque Wrench to ensure correct mounting of tools.
6 Nm - Part no. **1033-000132**

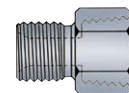

Adapters:

Male G 1/8" to Female 1/8" NPT
Part no. **1033-000154**



Male G 1/8" to Male 1/4" JIC
Part no. **1033-000153**



Male M5 to Male 1/4" JIC
For HYC-20-3200-064B only
Part no. **4005-000111**



Reduction Sleeves

See previous page



To prevent damage to the holder, round tool shanks without flats and with H6 tolerance **MUST** be used. Tool **MUST** be in the holder when clamping. Torque wrench **REQUIRED**.

GenGrip - Rear Activated (High Precision)

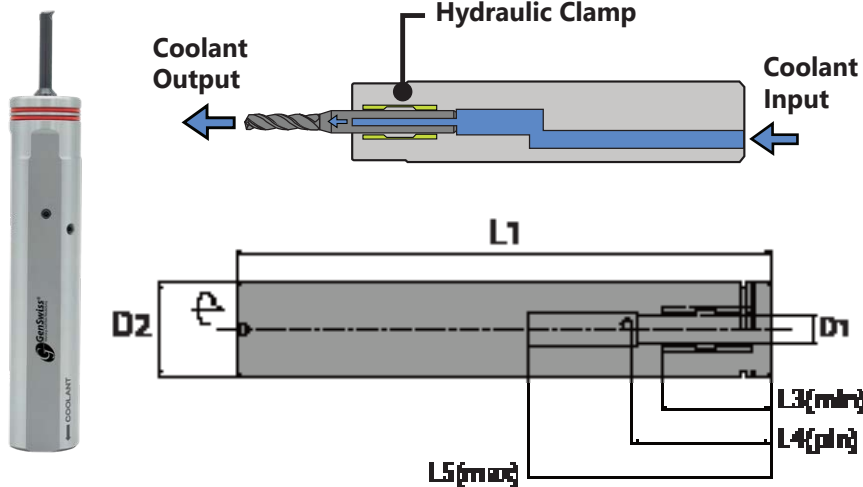

- Coolant-Thru ready
- h6 Tool shanks ONLY
- Torque wrench REQUIRED!
- Pair high precision holders with high precision micro sleeves to enable the use of smaller shank tools

CITIZEN

Shank Size (D2)	Bore Size (D1)	L1	L3	L4	L5	Description	Wrench No.
19.05	3	110	17.5	24	40	GRI-3.00-190110	1032-000229
	4	110	21	26	40	GRI-4.00-190110	1032-000229
	6	110	23	29	52	GRI-6.00-190110	1032-000229
	8	110	28	34	55	GRI-8.00-190110	1032-000229
25.4	3	110	17.5	24	40	GRI-3.00-254110	1032-000229
	4	110	21	26	40	GRI-4.00-254110	1032-000229
	6	110	23	29	52	GRI-4.00-254110	1032-000229
	8	110	28	34	55	GRI-8.00-254110	1032-000229
	10	110	29.5	36	55	GRI-10.0-254110	1032-000229
12	110	31.5	38	58	GRI-12.0-250110	1032-000229	

STAR

Shank Size (D2)	Bore Size (D1)	L1	L3	L4	L5	Description	Wrench No.
16	3	90	17.5	24	40	GRI-3.00-160090	1032-000229
	3.175	90	17.5	24	40	GRI-3.17-160090	1032-000229
	4	90	21	26	40	GRI-4.00-160090	1032-000229
	6	90	23	29	52	GRI-6.00-160090	1032-000229
22	3	110	17.5	24	40	GRI-3.00-220110	1032-000230
	4	110	21	26	40	GRI-4.00-220110	1032-000230
	6	110	23	29	52	GRI-6.00-220110	1032-000230
	8	110	28	34	55	GRI-8.00-220110	1032-000230
	10	110	29.5	36	55	GRI-10.0-220110	1032-000230
32	3	110	17.5	24	40	GRI-3.00-320110	1032-000230
	4	110	21	26	40	GRI-4.00-320110	1032-000230
	6	110	23	29	52	GRI-6.00-320110	1032-000230
	8	110	28	34	55	GRI-8.00-320120	1032-000230
	10	110	29.5	36	55	GRI-10.0-320120	1032-000230
	12	110	31.5	38	58	GRI-12.0-320120	1032-000230

TORNOS

Shank Size (D2)	Bore Size (D1)	L1	L3	L4	L5	Description	Wrench No.
16	3	50	17.5	24	28	GRI-3.00-160500	1032-000229
	3.175	50	17.5	24	28	GRI-3.17-160500	1032-000229
	4	50	21	26	28	GRI-4.00-160500	1032-000229
	3	90	17.5	24	40	GRI-3.00-160090	1032-000229
	3.175	90	17.5	24	40	GRI-3.17-160090	1032-000229
	4	90	21	26	40	GRI-4.00-160090	1032-000229
20	6	90	23	29	52	GRI-6.00-160090	1032-000229
	3	110	17.5	24	40	GRI-3.00-200110	1032-000229
	4	110	21	26	40	GRI-4.00-200110	1032-000229
	6	110	23	29	52	GRI-6.00-200110	1032-000229
22	8	110	28	34	55	GRI-8.00-200110	1032-000229
	3	110	17.5	24	40	GRI-3.00-220110	1032-000230
	4	110	21	26	40	GRI-4.00-220110	1032-000230
	6	110	23	29	52	GRI-6.00-220110	1032-000230
25	8	110	28	34	55	GRI-8.00-220110	1032-000230
	10	110	29.5	36	55	GRI-10.0-220110	1032-000230
	3	110	17.5	24	40	GRI-3.00-250110	1032-000230
	4	110	21	26	40	GRI-4.00-250110	1032-000230
25	6	110	23	29	52	GRI-6.00-250110	1032-000230
	8	110	28	34	55	GRI-8.00-250110	1032-000230
	10	110	29.5	36	55	GRI-10.0-250110	1032-000230
	12	110	31.5	38	58	GRI-12.0-250110	1032-000230

TSUGAMI

Shank Size (D2)	Bore Size (D1)	L1	L3	L4	L5	Description	Wrench No.
16	3	50	17.5	24	28	GRI-3.00-160500	1032-000229
	3.175	50	17.5	24	28	GRI-3.17-160500	1032-000229
	4	50	21	26	28	GRI-4.00-160500	1032-000229
20	3	110	17.5	24	40	GRI-3.00-200110	1032-000229
	4	110	21	26	40	GRI-4.00-200110	1032-000229
	6	110	23	29	52	GRI-6.00-200110	1032-000229
	8	110	28	34	55	GRI-8.00-200110	1032-000229
25	3	110	17.5	24	40	GRI-3.00-250110	1032-000230
	4	110	21	26	40	GRI-4.00-250110	1032-000230
	6	110	23	29	52	GRI-6.00-250110	1032-000230
	8	110	28	34	55	GRI-8.00-250110	1032-000230
	10	110	29.5	36	55	GRI-10.0-250110	1032-000230
	12	110	31.5	38	58	GRI-12.0-250110	1032-000230

Torque Wrench

Description	Hex Size	Force	Fits Shank Size
WTD-H03-3.0NM	3mm	3NM	16mm, 20mm, 3/4in
WTD-H04-3.0NM	4mm	3NM	22mm, 25mm, 32mm, 1in



CAUTION To prevent damage to the holder, round tool shanks without flats and with H6 tolerance MUST be used. Tool MUST be in the holder when clamping. Torque wrench REQUIRED.



- Coolant-Thru ready
- h6 Tool shanks ONLY
- Torque wrench REQUIRED!
- Pair high precision holders with high precision micro sleeves to enable the use of smaller shank tools

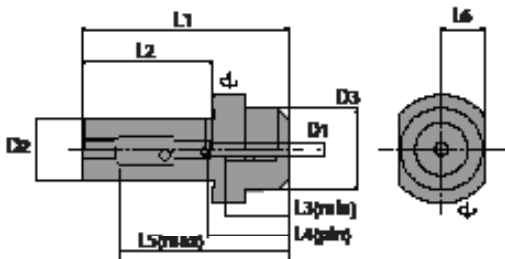

CITIZEN 3/4in Shank

Description	D1	D2	D3	L1	L2	L3	L4	L5	L6
GRI-3.00-190-40/63 CIT	3	19.05	20	63	40	17.5	24	53	13.5
GRI-4.00-190-40/63 CIT	4	19.05	22	63	40	21	26	53	14
GRI-6.00-190-40/63 CIT	6	19.05	24	63	40	23	29	53	15
GRI-8.00-190-40/63 CIT	8	19.05	26	63	40	28	34	53	16
GRI-10.0-190-40/63 CIT	10	19.05	28	63	40	29.5	36	53	17

NOTE: Use with torque wrench 1032-000230

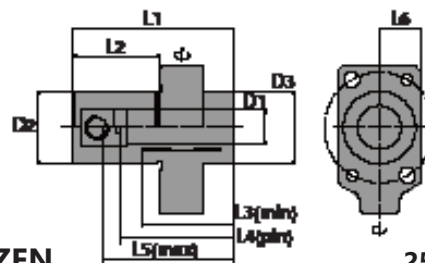

CITIZEN 25mm Shank

Description	D1	D2	D3	L1	L2	L3	L4	L5	L6
GRI-4.00-250-30/55 CIT	4	25	25	55	30	21	26	45	14.2
GRI-6.00-250-30/55 CIT	6	25	25	55	30	23	29	45	14.2
GRI-8.00-250-30/55 CIT	8	25	25	55	30	28	34	45	14.2
GRI-10.0-250-30/55 CIT	10	25	25	55	30	29.5	36	45	14.2
GRI-12.0-250-30/55 CIT	12	25	25	55	30	31.5	38	45	14.2

NOTE: Use with torque wrench 1032-000230

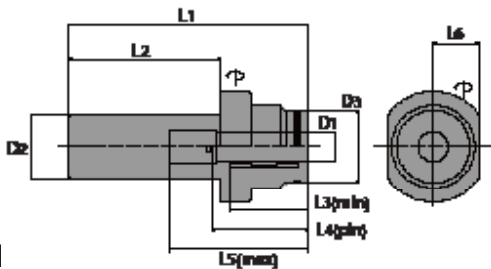

CITI Shank

Description	D1	D2	D3	L1	L2	L3	L4	L5	L6
GRI-4.00-254-40/75 CIT	4	25.4	19	75	30	21	26	46	14
GRI-6.00-254-40/75 CIT	6	25.4	20	75	30	23	29	51	15
GRI-8.00-254-40/75 CIT	8	25.4	23	75	30	28	36	51	16
GRI-10.0-254-40/75 CIT	10	25.4	27	75	30	29.5	36	56	17
GRI-12.0-254-40/75 CIT	12	25.4	29	75	30	31.5	38	56	18

NOTE: Use with torque wrench 1032-000230

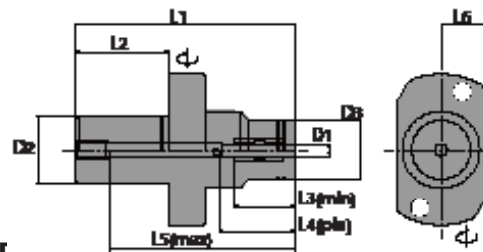

STAK Type-A

Description	D1	D2	D3	L1	L2	L3	L4	L5	L6
GRI-4.00-220-25/66A STA	4	22	19	66	25	21	26	56	14
GRI-6.00-220-25/66A STA	6	22	20	66	25	23	30	56	14
GRI-8.00-220-25/66A STA	8	22	23	66	25	28	34	56	15
GRI-10.0-220-25/66A STA	10	22	27	66	25	29.5	36	56	16
GRI-12.0-220-25/66A STA	12	22	29	66	25	31.5	42	56	17.25

NOTE: Use with torque wrench 1032-000230

STAR, TORNOS, & TSUGAMI Continued On Next Page

To prevent damage to the holder, round tool shanks without flats and with H6 tolerance MUST be used. Tool MUST be in the holder when clamping. Torque wrench REQUIRED.

GenGrip - Sub Spindle (High Precision)

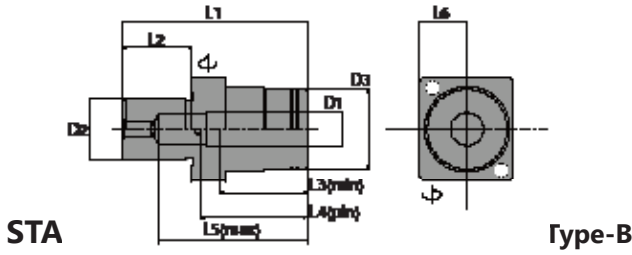

Description	D1	D2	D3	L1	L2	L3	L4	L5	L6
GRI-4.00-220-25/66B	4	22	19	66	25	21	26	56	16.25
GRI-6.00-220-25/66B	6	22	20	66	25	23	30	56	16.25
GRI-8.00-220-25/66B	8	22	23	66	25	28	34	56	16.25
GRI-10.0-220-25/66B	10	22	27	66	25	29.5	36	56	16.25
GRI-12.0-220-25/66B	12	22	29	66	25	31.5	42	56	17.25

NOTE: Use with torque wrench 1032-000230

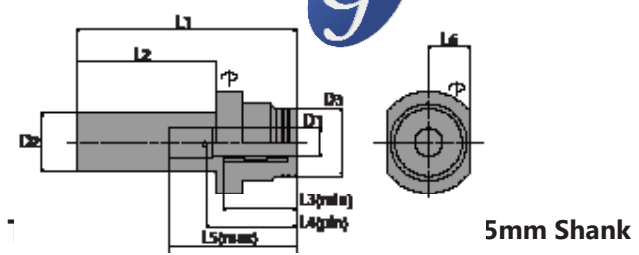

Description	D1	D2	D3	L1	L2	L3	L4	L5	L6
GRI-4.00-200-40/75	4	20	19	75	40	21	26	46	14
GRI-6.00-200-40/75	6	20	20	75	40	23	29	51	15
GRI-8.00-200-40/75	8	20	23	75	40	28	36	51	16
GRI-10.0-200-40/75	10	20	27	75	40	29.5	36	56	17
GRI-4.00-250-60/95	4	25	19	95	60	21	26	46	14
GRI-6.00-250-60/95	6	25	20	95	60	23	29	51	15
GRI-8.00-250-60/95	8	25	23	95	60	28	34	51	16
GRI-10.0-250-60/95	10	25	27	95	60	29.5	36	56	17
GRI-12.0-250-60/95	12	25	29	95	60	31.5	38	56	18

NOTE: Use with torque wrench 1032-000230

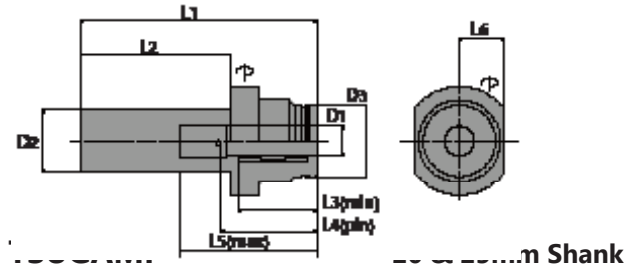

Description	D1	D2	D3	L1	L2	L3	L4	L5	L6
GRI-4.00-200-40/75	4	20	19	75	40	21	26	46	14
GRI-6.00-200-40/75	6	20	20	75	40	23	29	51	15
GRI-8.00-200-40/75	8	20	23	75	40	28	36	51	16
GRI-10.0-200-40/75	10	20	27	75	40	29.5	36	56	17
GRI-4.00-250-60/95	4	25	19	95	60	21	26	46	14
GRI-6.00-250-60/95	6	25	20	95	60	23	29	51	15
GRI-8.00-250-60/95	8	25	23	95	60	28	34	51	16
GRI-10.0-250-60/95	10	25	27	95	60	29.5	36	56	17
GRI-12.0-250-60/95	12	25	29	95	60	31.5	38	56	18

NOTE: Use with torque wrench 1032-000230

Torque Wrench

Description	Hex Size	Force	Fits Shank Size
WTD-H03-3.0NM	3mm	3NM	16mm, 20mm, 3/4in
WTD-H04-3.0NM	4mm	3NM	22mm, 25mm, 32mm, 1in



Also Available
Hanwha & Nexturn

GenGrip High Precision Micro Sleeve & Pin Positioning Kits

Micro Sleeve Enables Use Of Small Tool Shanks

Use with 8mm & 12mm High Precision GenGrip bore sizes

8mm Shank

Description	D1	D2	D3	L1	L2
GRIS-08-3.00	3	8	12.5	35.5	2
GRIS-08-4.00	4	8	12.5	35.5	2
GRIS-08-5.00	5	8	12.5	35.5	2
GRIS-08-6.00	6	8	12.5	35.5	2
GRIS-08-3.18	1/8in	8	12.5	35.5	2
GRIS-08-4.76	3/16in	8	12.5	35.5	2
GRIS-08-6.35	1/4in	8	12.5	35.5	2

12mm Shank

Description	D1	D2	D3	L1	L2
GRIS-12-3.00	3	12	19	45	2
GRIS-12-4.00	4	12	19	45	2
GRIS-12-5.00	5	12	19	45	2
GRIS-12-6.00	6	12	19	45	2
GRIS-12-7.00	7	12	19	45	2
GRIS-12-8.00	8	12	19	45	2
GRIS-12-9.00	9	12	19	45	2
GRIS-12-10.00	10	12	19	45	2
GRIS-12-3.18	1/8in	12	19	45	2
GRIS-12-4.76	3/16in	12	19	45	2
GRIS-08-6.35	1/4in	12	19	45	2

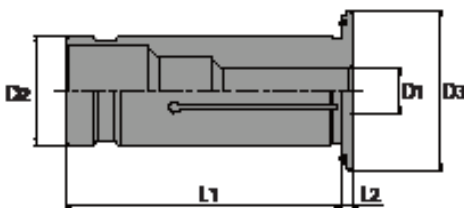

Positioning Pin Kit

Positioning Pin Kit	Fits GenGrip Dimensions	
	D2	D1
P2.5x8	16mm	All
	19.05mm	3-6mm
	20mm	3-6mm
P2.5x10	20mm	8-10mm
	19.05mm	8-10mm
P2.5x12	22mm	All
	25mm	All
P2.5x16	32mm	All

Kits Include: 4 Set Screws, 2 Pins, & 1 Allen Wrench

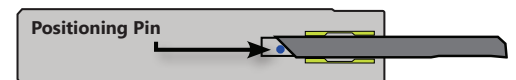

To prevent damage to the holder, round tool shanks without flats and with H6 tolerance MUST be used. Tool MUST be in the holder when clamping. Torque wrench REQUIRED.

www.genswiss.com
1-413-562-4800
sales@genswiss.com